

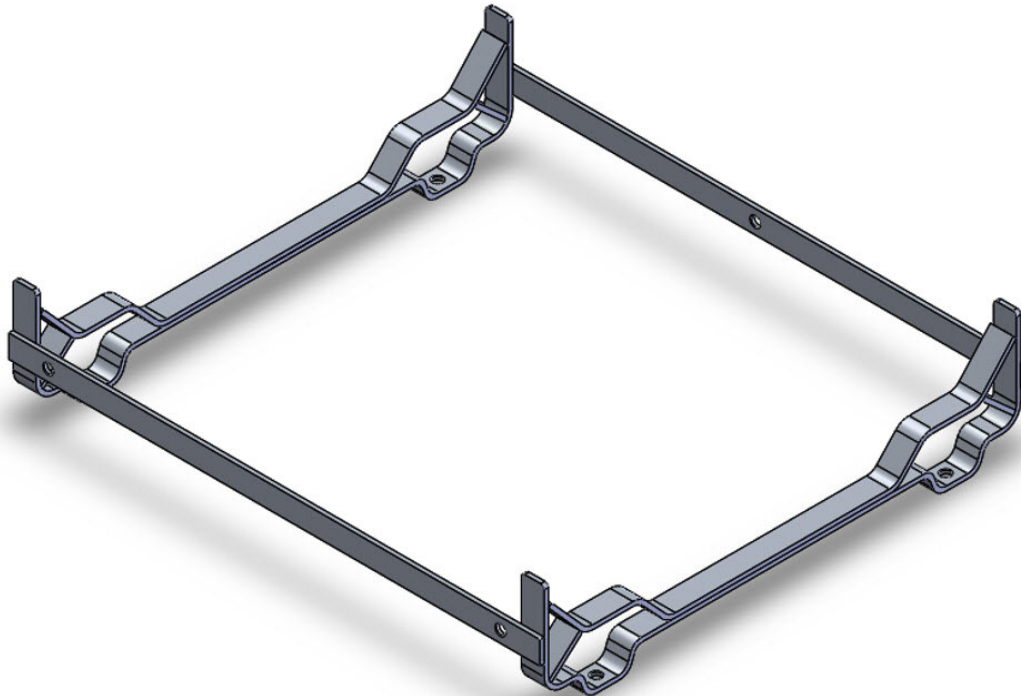

Aluminium deck cradle, including lashing for 8DK+ & 12DK+ in low profile container

Item number: 1007946



A standard deck cradle designed to meet the requirements for stowage of your VIKING liferaft in a marine and offshore environment. A proven structure that has been used by VIKING for decades. The cradle should be mounted by bolting to the hull foundation support.

Bolt, washers and nuts will not be supplied by VIKING as they may differ in length depending on the support foundation onboard. Pre-drilled foundation holes have a diameter of Ø12.

Cradle fits the following liferaft sizes:

- 8DK+
- 12DK+

Material:	Aluminium EN AW 6060 (AlMgSi0.5)
Dimensions:	H166xW740xD676 mm
Weight:	2.6 kg
Welding:	According to DS/EN 10042 class C
Lashing for fixing of liferaft:	Included