

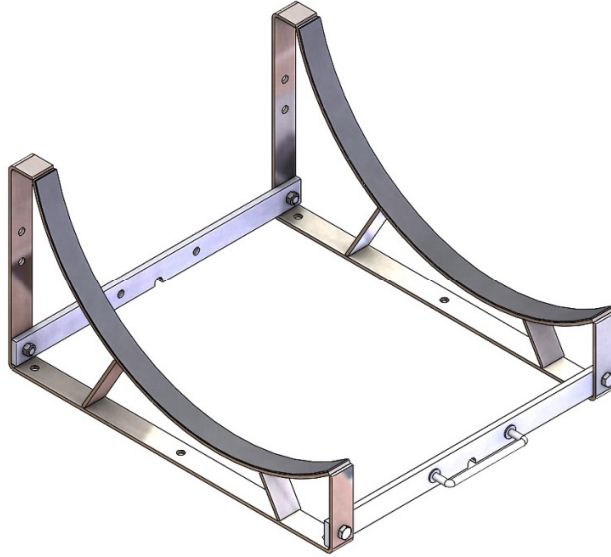

Galvanized deck cradle, including lashing for 12DKS, 20-25DK+, 50-65DKR & 50IBA

Material no.: 1000053



A standard deck cradle designed to meet the requirements for stowage of your VIKING liferaft in a marine and offshore environment. A proven structure that has been used by VIKING for decades. The cradle should be mounted by bolting to the hull foundation support.

Bolt, washers and nuts will not be supplied by VIKING as they may differ in length depending on the support foundation onboard. Pre-drilled foundation holes have a diameter of Ø12.

Cradle fits the following liferaft sizes:

- 12DKS
- 20DK+
- 25DK+
- 50DKR
- 65DKR
- 50IBA

Material:	Black steel (S235JR/EN10025/SS400/TIS1479)
Dimensions:	H340xW545xD620 mm
Weight:	10.5 kg
Surface treatment:	Hot dip galvanized class A JF, DS/ISO 1464t dip galvanized class A JF, DS/ISO 1461
Welding:	According to DS/EN 5871 class C
Lashing for fixing of liferaft:	Included